



# Platform Levelling

**Platform Levelling must be performed prior to first print or when prints are not sticking to the printing platform**

**Print button**

**Home button**

**Slide paper underneath nozzle**

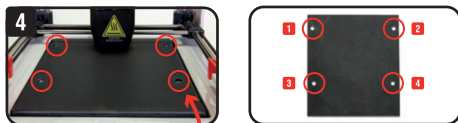
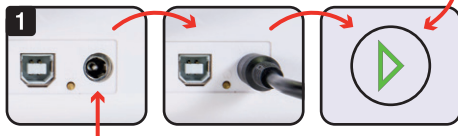

**Adjustment screws**

**5**

**Scan me:**



**Humbrol.com**

**1.** Plug the printer into the mains power supply using the 'Power Supply' provided. You should notice the 'Print' button on the front of the 3D printer light up solid green.

**2.** Press the 'Home' button  on the reverse of the printer to allow the printing head return to it's start position. Once finished, **remove** the 'Power Supply' cable from the printer.

**3.** *Attempt to* slot this piece of paper underneath the printer nozzle in one of the 4 corners of the printer bed; manually move the printer head if required (**Ensure all power is disconnected**).

**4.** The piece of paper should be lightly pinched by the nozzle, but the paper should still be able to be removed with ease.

Adjustments can be made to the height of the printer bed using the screwdriver provided and adjusting the tightness of the screws in the **4 respective corners**. Ensure all 4 corners of the print bed are adjusted accordingly.

**5.** Scan the QR code or visit **Humbrol.com** to proceed to the main instructional manual.